

## 12. RAILS / REMBARDES

604 140 532E ASSY. REAR HANDRAIL

*ENS. REMBARDE ARRIERE*



REP ITM	CODE SERCEL PART NUM.	DESIGNATION DESCRIPTION	REFERENCE / SPECIF / LA PART NUMBER / SPECIF.	QTE QTY
1	211111349	VIS H M 12-35 8.8 ZB. / BOLT HEX ZINC-PLATED	SERCEL	50
2	211111369	VIS H M12-40 8.8 ZB. / BOLT HEX ZINC-PLATED	SERCEL	4
3	216411120	ECROU M12, B. PLAST CL8 Z.B / NUT LOCK	SERCEL	54
4	217141120	RONDELLE M12,U,Z.B / PLAIN HEAVY DUTY WASHER	SERCEL	108
5	400184032	EXTENSION W.W. LIFT D. / W.W EXTENSION	SERCEL	1
6	400184522	EXTENSION W.W. LIFT G. / W.W EXTENSION	SERCEL	1
7	400201053	SOUDURE MAIN COURANTE AR.D. / REAR R. HANDLE WELDING	SERCEL	1
8	400201063	SOUDURE MAIN COURANTE AR.G. / REAR L. HANDLE WELDING	SERCEL	1
9	400201072	SOUDURE MAIN COURANTE LIFT G. / LIFT L. HANDLE WELDING	SERCEL	1
10	400201082	SOUDURE MAIN COURANTE LIFT D. / LIFT R. HANDLE WELDING	SERCEL	1

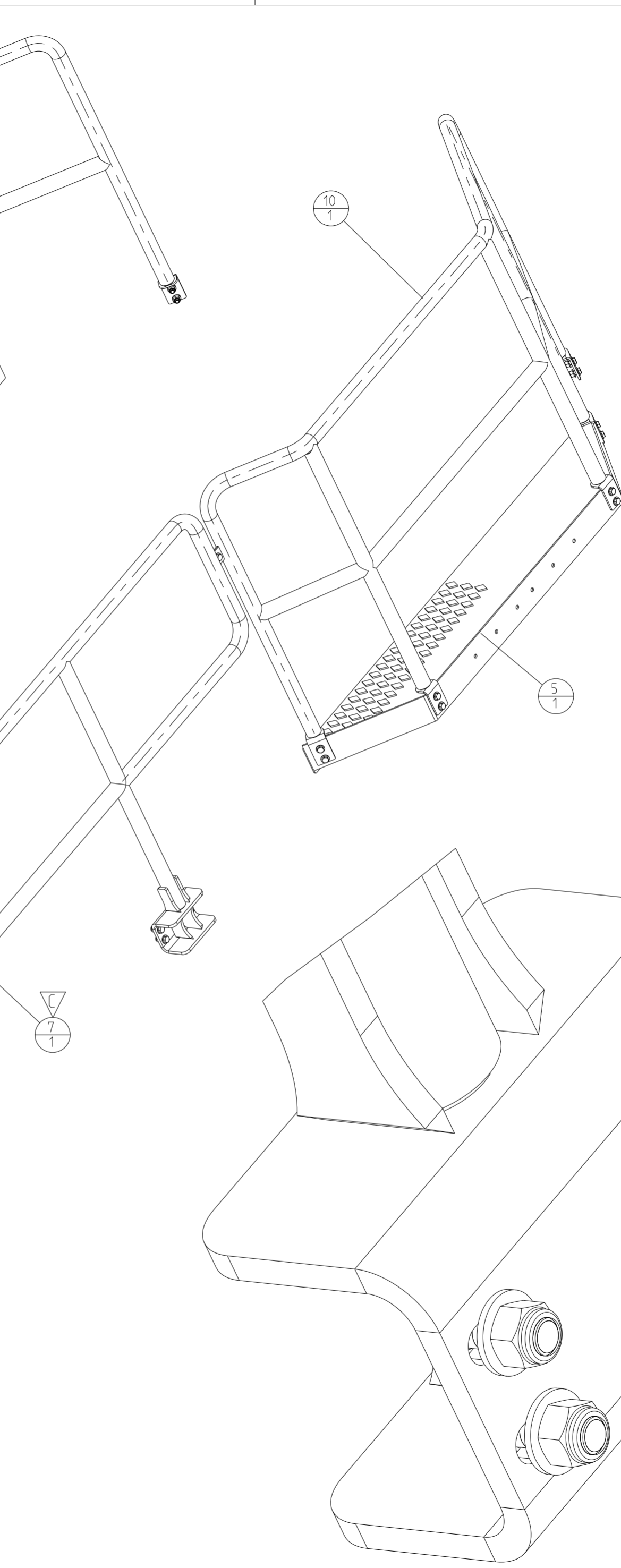
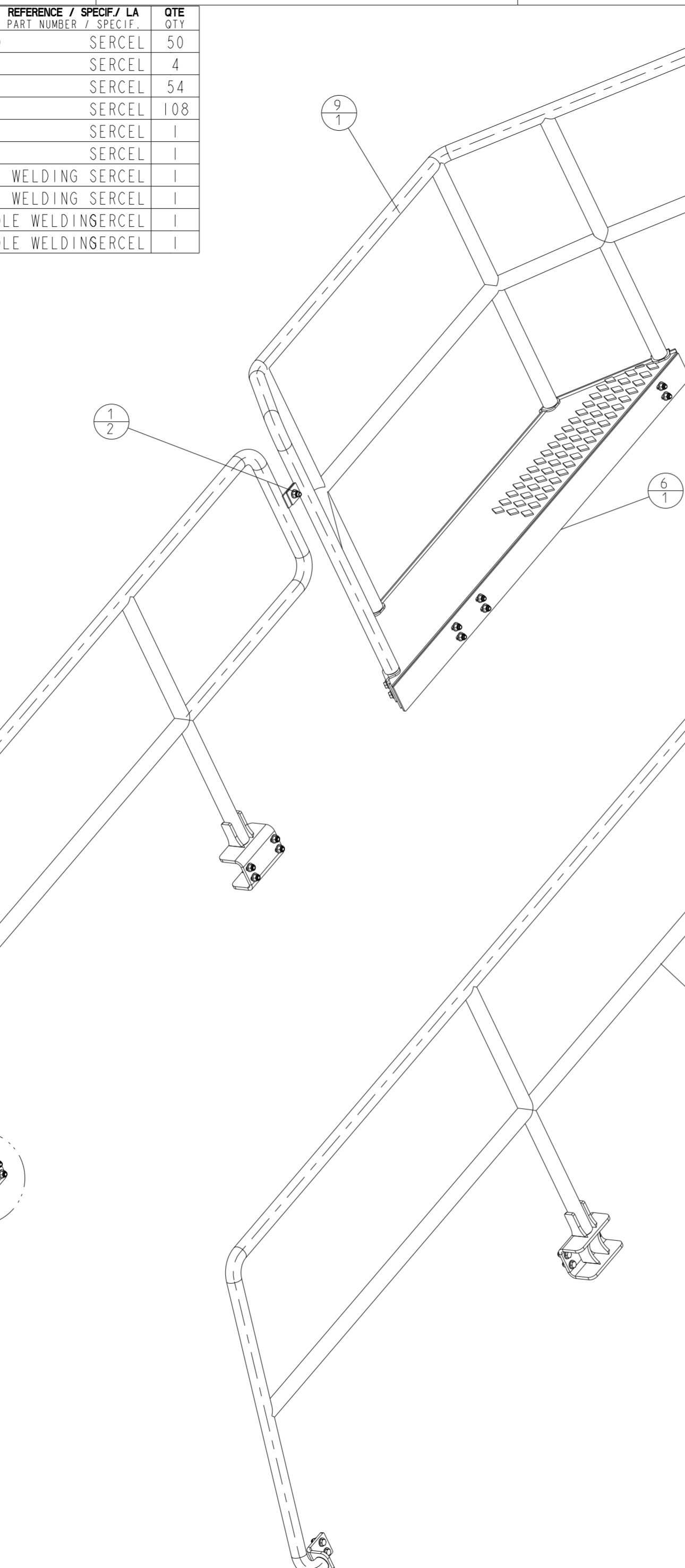
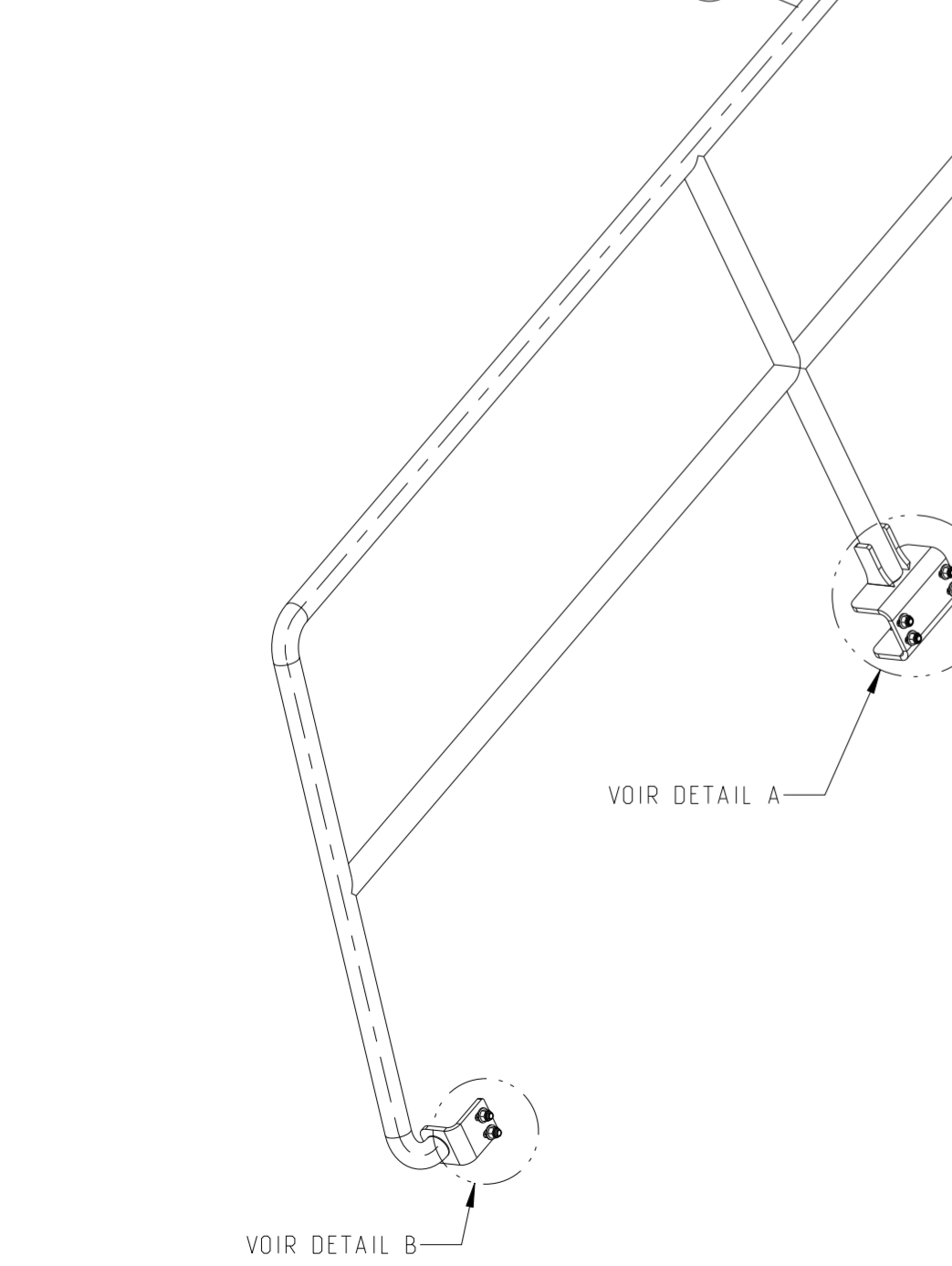
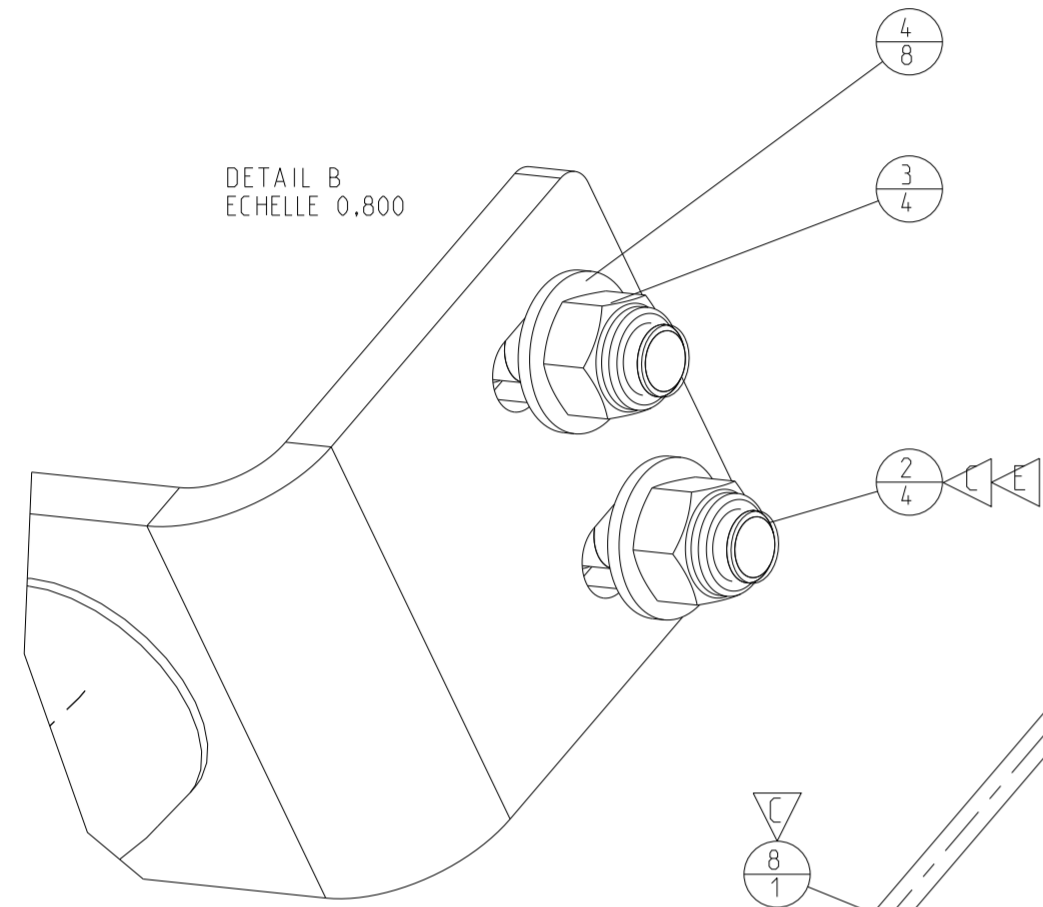

F	ECO 206137	VIAULES T.	24/09/15	BUTTIN P.	24/09/15	Signé P. Buttin
E	AM 115728	PB	10-10-2011	PB	10-10-2011	Signé P. Buttin
D	AM10 4598	VALENTE D.	24/11/10	BUTTIN P.	24/11/10	
C	DM06-1919	GUILLOU	17/03/06	CARDEC	17/03/06	
B	CREATION	GUILLOU	Sep-24-15	BUTTIN P.	Sep-24-15	
A	NATURE DE LA MODIFICATION TYPE OF MODIFICATION	DESSINE/VERIFIE DRAWN/VERIFIED	DATE	VISA	DATE	VISA
REV/D/T	MATIERE/MATERIAL:	COULEUR/COLOR:	MASSE/WEIGHT:	APPROUVE APPROVED	DATE	VISA
	TRAITEMENT/TREATMENT:	VOLUME: m.3				
LE PLAN ORIGINAL SIGNE EST AU PLANEX						
TITRE/TITLE						
<b>NOMAD65</b>						
OPT. MAIN COURANTE DIAM 50 AR / OPT. HANDLE DIAM 50 REAR						
SUIVANT INSTRUCTION: S902000324						
CE PLAN EST LA PROPRIETE INALIENABLE DE SERCEL ETABLISSEMENT DE SAINT GAUDENS						
NUMERO DE PLAN / DRAWING REFERENCE: 604140532						
Echelle: 0.080						
Scale: 0.080						
CLO: REF: 04						
Folio: 1/1						

